

# Cuba D'Viajeros Locator Form – How To Guide

1. Within 48 hours of your arrival to Cuba, go to <https://www.dviajeros.mitrans.gob.cu/inicio>. If you prefer to complete the form in English, right click in the browser and select 'Translate to English'.

## Solicite su formulario para brindar información adelantada de entrada a la República de Cuba

Formulario digital requerido por varias instituciones que permite el ingreso al territorio nacional de Cuba.

[Crear Formulario](#) [Editar Formulario](#)

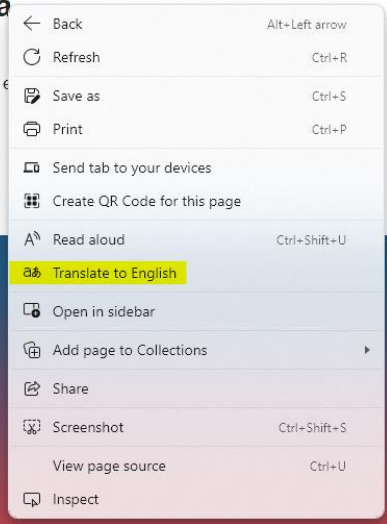

### ¿NECESAS INFORMACIÓN DE VIAJEROS?

mejora la experiencia de los viajeros en su tránsito por la adelantada para agilizar trámites en los diferentes puntos de a pasajero completar con veracidad la información brindada ción y Extranjería, la Aduana General de la República y el

2. Click 'Create Form/Crear Formulario':



A screenshot of the D'Viajeros website. The header shows the logo, 'D'VIAJEROS Advance Traveler Information', and the time '06:47:15 AM Cuba Local Time'. Below the header is a banner for 'FERIA INTERNACIONAL DE TURISMO' with a date 'DEL 1 AL 5 DE MAYO 2024' and 'Jardines del Rey 2024'. The main content area features an illustration of people with luggage and a plane, with the text 'Request your form to provide advance entry information to the Republic of Cuba'. Below this text are two buttons: 'Create Form' (circled in red) and 'Edit Form'.

### Request your form to provide advance entry information to the Republic of Cuba

Digital form required by several institutions that allows entry into the national territory of Cuba.

[Create Form](#) [Edit Form](#)

- 3. **Personal Information:** Complete all starred fields and click 'Following/Siguiente'. If you complete the form in Spanish, United Kingdom is listed as 'Reino Unido'.



### Personal information

The data you have (\*) is mandatory

<b>First name(*)</b>	Second name
<input type="text"/>	<input type="text"/>
<b>Surname(*)</b>	Second surname
<input type="text"/>	<input type="text"/>
<b>Birthdate (*)</b>	<b>Gender(*)</b>
Day: <input type="text" value="xx"/> We: <input type="text" value="xx"/> Year: <input type="text" value="xxxx"/>	<input type="text" value="Select"/>
<b>Country where the person was born (*)</b>	Identity No. Only for Cubans
<input type="text" value="Select"/>	<input type="text"/>
<b>Country of issue of the travel document with which you will enter the country (*)</b>	<b>Passport number with which you will enter the country (*)</b>
<input type="text" value="Select"/>	<input type="text"/>
<b>Country of permanent residence (*)</b>	Mail
<input type="text" value="Select"/>	<input type="text"/>
Telephone	Another phone
<input type="text"/>	<input type="text"/>

4. **Flight details:** Complete all starred fields with your flight information. Please select 'Visit/Visita' as your reason for travel. Click 'Following/Siguiente'.

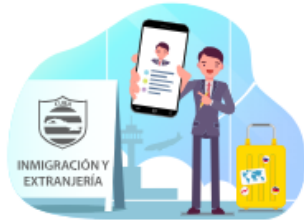

### Immigration Information

The data you have (\*) is mandatory

Arrival date (*)	Flight number (*)
<input type="text" value="dd/05/2024"/>	<input type="text"/>
Airline Name (*)	Seat number
<input type="text" value="Select"/>	<input type="text"/>
Entry point to Cuba (*)	Country of origin of the Traveler (*)
<input type="text" value="Al José Martí (Havana / HAV)"/>	<input type="text" value="United Kingdom"/>
Reason for trip (*)	Organism (*)
<input type="text" value="Visit"/>	<input type="text"/>

5. **Accommodation:** Complete all starred fields with the details of your arrival accommodation, which you will find on your Final Joining Instructions. Under 'Accommodation location/Lugar de alojamiento', you must select 'House rent/Casa renta'. The Province is 'Havana/La Habana'. Click 'Following/Siguiente'.

## Health Information

The data you have (\*) is mandatory

<b>Accommodation location (*)</b> Casa renta	<b>Address (*)</b> Calle Lamparilla 413 E/ Bernaza Y Villeç
<b>Province where you are going (*)</b> La Habana	Municipality where you are going Select
Countries visited in the last 15 days Select	Symptoms in the last 15 days Select
Questionnaire Select	
<input type="checkbox"/> Vaccination	<input type="checkbox"/> RT-PCR Test (NAAT)
Vaccine Seleccione	PCR date dd/mm/yyyy
Scheme <input type="radio"/> Complete <input type="radio"/> Incomplete	Laboratory <input type="text"/>
	Result <input type="radio"/> Positive <input type="radio"/> Negative

**Former** **Following**

- 6. **Customs Information:** Please complete the starred fields – the first and last question on this page. ‘Unaccompanied baggage’ refers to hold baggage. Click ‘Following/Siguiente’.

### Customs Information

The data you have (\*) is mandatory

Unaccompanied baggage (\*)  Yeah  No

No. Accompanying children under 10 years old

The import of Freely Convertible Currency (MLC) is free. Declare the total amount when it is greater than five thousand US dollars (USD 5,000) or its equivalent in other MLCs in cash or security.

Currency  Amount

In addition to his personal effects, he brings miscellaneous goods to import, such as: footwear, clothing, food, personal hygiene and household items, jewelry, lingerie, perfumery and the like; worth up to one thousand US dollars (USD 1000):

Items you bring with you or in your luggage

List of equipment and items (appliances and others) that you bring, which are not classified as miscellaneous

Category	Article	Amount	Amount
<input type="text" value="Selecicio"/>	<input type="text" value="Select"/>	<input type="text" value="0"/>	<input type="text" value="(USD)"/>

MINCOM Technical Authorization Number for Import

Do you have something to declare at customs? (\*)

Yeah  No

- 7. **Sworn declaration:** Tick 'I agree/Estoy de acuerdo'. Click 'Following/Siguiente'.



I declare that all the information provided in this form is true and complete, I understand that any omission or inaccuracy violates the provisions of the authorities of the Republic of Cuba.

I agree



Which is the code?

Former

Following